

MEMORANDUM

TO: City Council

FROM: David Ricks, Director of Public Works

CC: Douglas L. Smith, Interim City Manager  
Bernard Pishko, City Attorney  
Breck Daughtrey, City Clerk

SUBJECT: Camp Allen Update

DATE: February 23, 2017

This memorandum is a follow-up to the Camp Allen progress report included as part of the CIP major projects update given during the January 10 council worksession.

The groundbreaking ceremony for Camp Allen Elementary School took place this past Tuesday, February 21, marking both the start of construction for another state-of-the-art school in Norfolk and the final stage of a multi-year project to construct five schools throughout the city.

In 2013, City Council committed to building five new schools – Campostella STEM K-8, Richard H. Bowling Jr. Elementary, Larchmont Elementary, Ocean View Elementary, and Camp Allen Elementary. To make this commitment a reality, the real estate tax was increased by four cents in fiscal year (FY) 2014, with two cents dedicated to accelerate school construction. Through FY 2017, the tax increase has generated \$13.7 million for school construction.

The estimated cost of construction for Camp Allen is currently \$28.7 million, and completion of this project is made possible through the city's ongoing financial commitment as well as a federal grant from the Department of Defense. The federal grant provides 80 percent of the necessary funds (\$22.9 million) and the city will provide the remaining 20 percent (\$5.7 million). This investment will result in a newly constructed 97,500 square foot school with the capacity to serve 571 students (Camp Allen currently serves 449 students).

The ordinance accepting the \$22.9 million federal grant is on the docket for council approval on Tuesday, February 28.



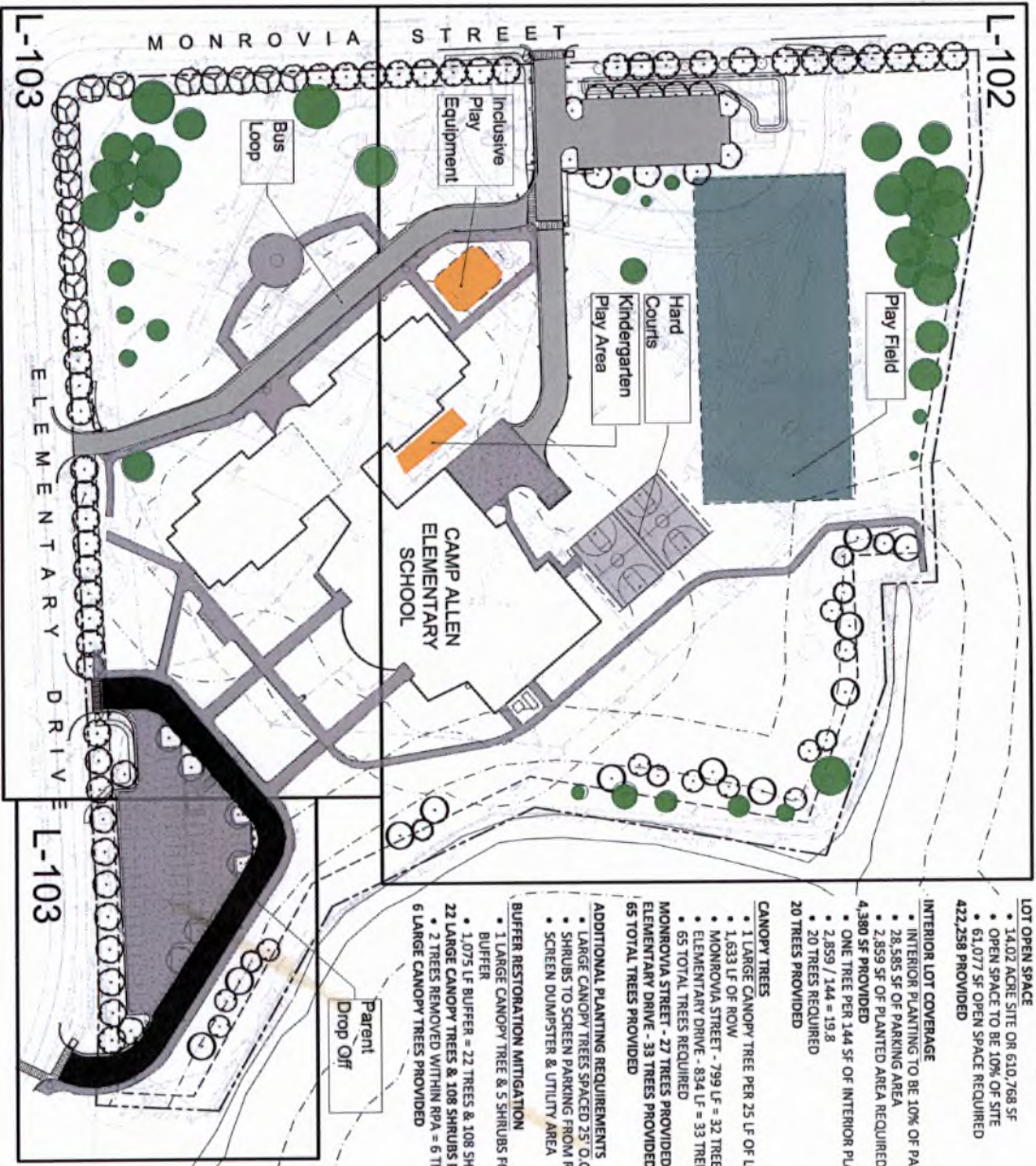

- LOT OPEN SPACE**
- 14.02 ACRE SITE OR 610,768 SF
  - OPEN SPACE TO BE 10% OF SITE
  - 61,077 SF OPEN SPACE REQUIRED
  - 422,258 PROVIDED

- INTERIOR LOT COVERAGE**
- INTERIOR PLANTING TO BE 10% OF PARKING AREA
  - 26,585 SF OF PARKING AREA
  - 2,859 SF OF PLANTED AREA REQUIRED
  - 4,380 SF PROVIDED
  - ONE TREE PER 144 SF OF INTERIOR PLANTING
  - 2,859 / 144 = 19.8
  - 20 TREES REQUIRED
  - 20 TREES PROVIDED

- CANOPY TREES**
- 1 LARGE CANOPY TREE PER 25 LF OF LOT WIDTH
  - 1,633 LF OF ROW
  - MONROVIA STREET - 799 LF = 32 TREES REQUIRED
  - ELEMENANT DRIVE - 834 LF = 33 TREES REQUIRED
  - 65 TOTAL TREES REQUIRED
  - MONROVIA STREET - 27 TREES PROVIDED / 5 TREES PRESERVED (32 TOTAL)
  - ELEMENANTARY DRIVE - 33 TREES PROVIDED
  - 65 TOTAL TREES PROVIDED

- ADDITIONAL PLANTING REQUIREMENTS**
- LARGE CANOPY TREES SPACED 25' O.C. AROUND PARKING
  - SHRUBS TO SCREEN PARKING FROM ROAD IN 6 FOOT BED
  - SCREEN DUMPSTER & UTILITY AREA

- BUFFER RESTORATION MITIGATION**
- 1 LARGE CANOPY TREE & 5 SHRUBS FOR EVERY 50' LF OF 50' WETLAND
  - BUFFER
  - 1,075 LF BUFFER = 22 TREES & 108 SHRUBS REQUIRED
  - 22 LARGE CANOPY TREES & 108 SHRUBS PROVIDED
  - 2 TREES REMOVED WITHIN RPA = 6 TREES REQUIRED
  - 6 LARGE CANOPY TREES PROVIDED

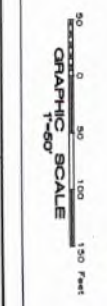

PROJECT	CITY OF NORFOLK AND NORFOLK PUBLIC SCHOOLS
	CAMP ALLEN ELEMENTARY SCHOOL
DRAWING	OVERALL PLANTING PLAN

DATE	09-15-14
PROJECT DESIGNED	DC
DRAWN	DC
CHECKED	MS

mark	date	by	description
revisions			



SHEET  
L-101