

LAKE BURNT MILLS

PAGE 3

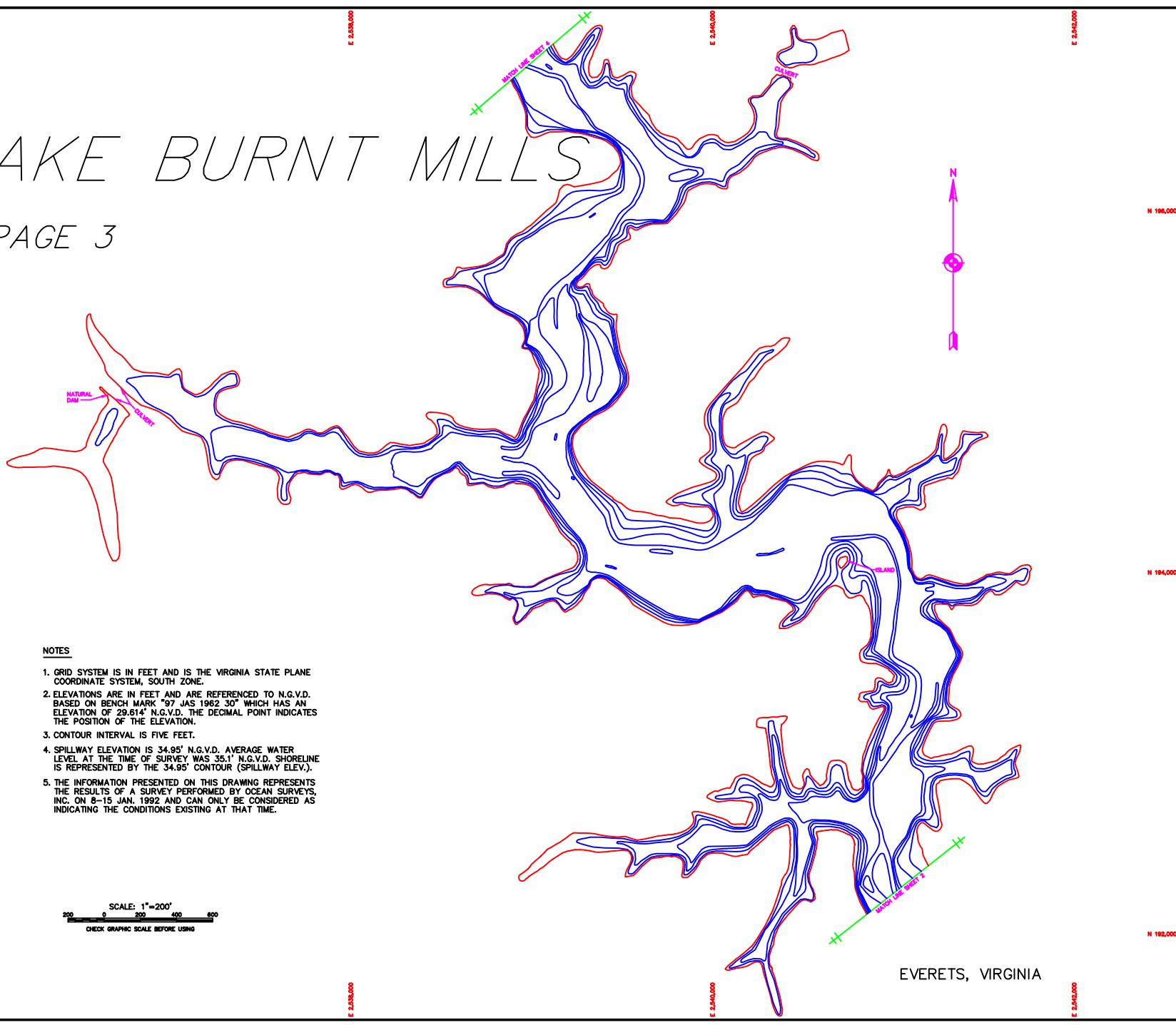

NOTES

1. GRID SYSTEM IS IN FEET AND IS THE VIRGINIA STATE PLANE COORDINATE SYSTEM, SOUTH ZONE.
2. ELEVATIONS ARE IN FEET AND ARE REFERENCED TO N.G.V.D. BASED ON BENCH MARK "97 JAS 1962 30" WHICH HAS AN ELEVATION OF 29.614' N.G.V.D. THE DECIMAL POINT INDICATES THE POSITION OF THE ELEVATION.
3. CONTOUR INTERVAL IS FIVE FEET.
4. SPILLWAY ELEVATION IS 34.95' N.G.V.D. AVERAGE WATER LEVEL AT THE TIME OF SURVEY WAS 35.1' N.G.V.D. SHORELINE IS REPRESENTED BY THE 34.95' CONTOUR (SPILLWAY ELEV.).
5. THE INFORMATION PRESENTED ON THIS DRAWING REPRESENTS THE RESULTS OF A SURVEY PERFORMED BY OCEAN SURVEYS, INC. ON 8-15 JAN. 1992 AND CAN ONLY BE CONSIDERED AS INDICATING THE CONDITIONS EXISTING AT THAT TIME.

SCALE: 1"=200'
0 200 400 600
CHECK GRAPHIC SCALE BEFORE USING

EVERETS, VIRGINIA