

LITTLE CREEK RESERVOIR

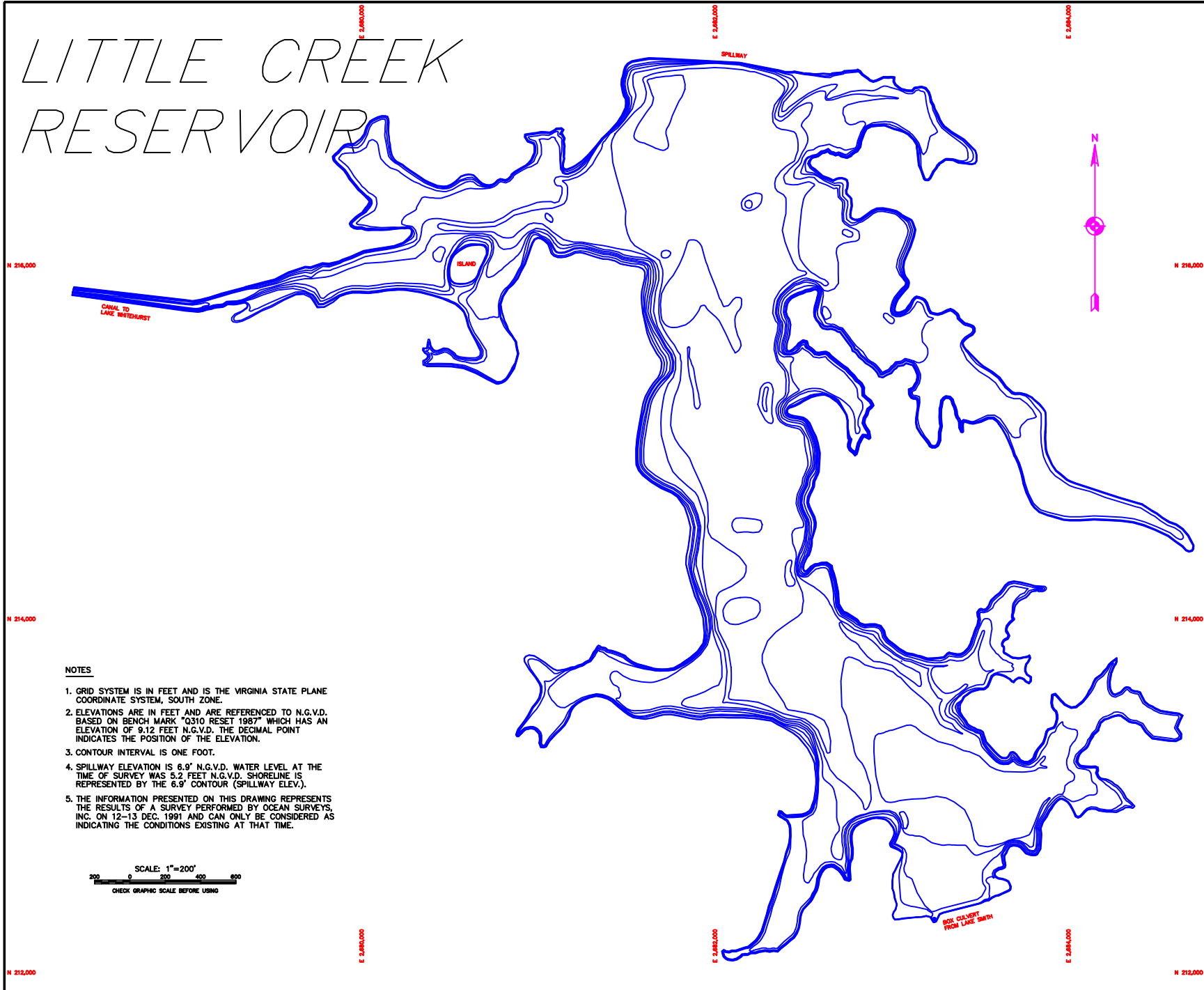

NOTES

1. GRID SYSTEM IS IN FEET AND IS THE VIRGINIA STATE PLANE COORDINATE SYSTEM, SOUTH ZONE.
2. ELEVATIONS ARE IN FEET AND ARE REFERENCED TO N.G.V.D. BASED ON BENCH MARK "Q310 RESET 1987" WHICH HAS AN ELEVATION OF 9.12 FEET N.G.V.D. THE DECIMAL POINT INDICATES THE POSITION OF THE ELEVATION.
3. CONTOUR INTERVAL IS ONE FOOT.
4. SPILLWAY ELEVATION IS 6.9' N.G.V.D. WATER LEVEL AT THE TIME OF SURVEY WAS 5.2 FEET N.G.V.D. SHORELINE IS REPRESENTED BY THE 6.9' CONTOUR (SPILLWAY ELEV.).
5. THE INFORMATION PRESENTED ON THIS DRAWING REPRESENTS THE RESULTS OF A SURVEY PERFORMED BY OCEAN SURVEYS, INC. ON 12-13 DEC. 1991 AND CAN ONLY BE CONSIDERED AS INDICATING THE CONDITIONS EXISTING AT THAT TIME.

SCALE: 1"=200'
200 0 200 400 600
CHECK GRAPHIC SCALE BEFORE USING